



Payment Schedule

3.5 MARLA DOUBLE STOREY VILLA

Booking (10%)	950,000
Allocation (8%)	760,000
Confirmation (7%)	665,000
Monthly Installment	$35,000 \times 47 = 1,645,000$
Half Yearly Installment	$450,556 \times 9 = 4,055,000$
On Possession 1.6 Year (15%)	1,425,000
TOTAL COST	9,500,000

Notes

- 10% Discount on Lump sum and 5% on 50% Payment.
- Mentioned Payment Plan and Prices are subject to change without any Notice.
- All Construction Charges and Development Charges are including in this price.
- After the 10th date of every single month Rs. 500 will be charged for each day as a penalty on late payment.
- Real Investment Marketing is the only authorized company to receive payments on behalf of "INNOMATRIX BUILDERS & DEVELOPERS SMC PVT LTD"

Prime Location Charges:

Corner (5%)
50 Feet Wide Road (5%)

Name: _____ Villa No: _____

Block: _____ Size: _____ Street No: _____ Category: _____

Total Cost: _____

Read, Understood & Signature: _____

Company Stamp & Signature _____

A Project of



Marketed by



+92 51 848 8110

Opal Villas, Adjacent Eden Life,
Moza Herno, Thanda Pani, Islamabad
opalvillas.isb@gmail.com | www.opalvillas.pk

3.5 MARLA DOUBLE STOREY VILLA



Ground Floor



First Floor

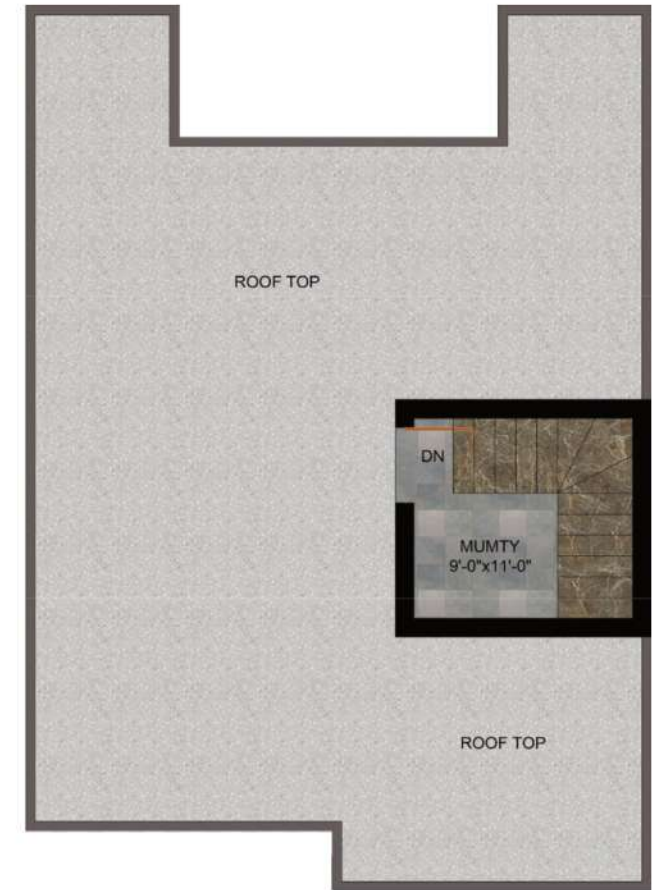

Roof Top





FIRST FLOOR

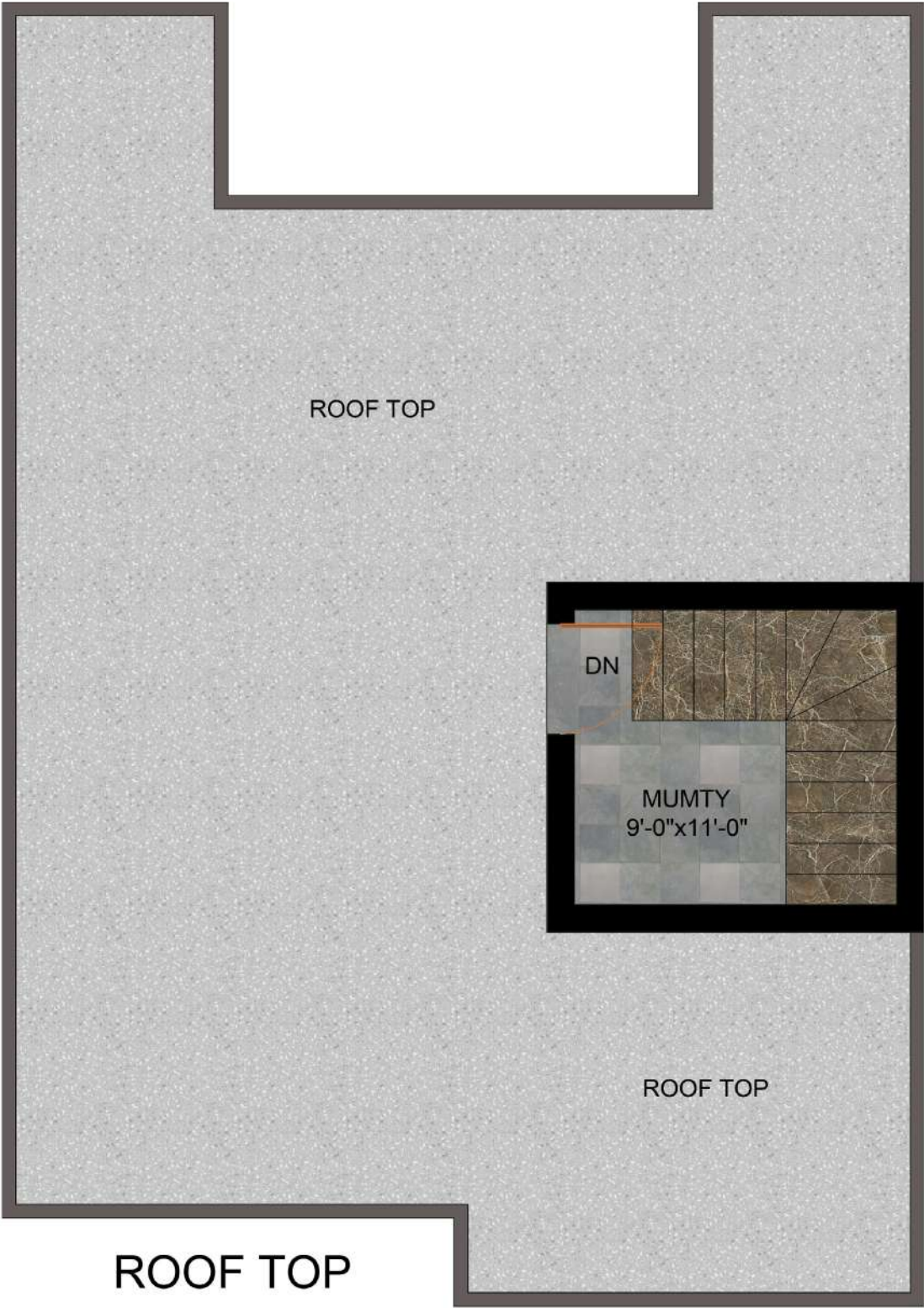

ROOF TOP

DN

MUMTY
9'-0"x11'-0"

ROOF TOP

ROOF TOP



















