



## Payment Schedule

### 3.5 MARLA SINGLE STOREY VILLA

Booking (10%)	650,000
Allocation (8%)	520,000
Confirmation (7%)	455,000
Monthly Installment	25,000 x 47 = 1,175,000
Half Yearly Installment	302,778 x 9 = 2,725,000
On Possession 1.6 Year (15%)	975,000
<b>TOTAL COST</b>	<b>6,500,000</b>

#### Notes

- 10% Discount on Lump sum and 5% on 50% Payment.
- Mentioned Payment Plan and Prices are subject to change without any Notice.
- All Construction Charges and Development Charges are including in this price.
- After the 10th date of every single month Rs. 500 will be charged for each day as a penalty on late payment.
- Real Investment Marketing is the only authorized company to receive payments on behalf of "INNOMATRIX BUILDERS & DEVELOPERS SMC PVT LTD"

#### Prime Location Charges:

Corner (5%)  
50 Feet Wide Road (5%)

Name: \_\_\_\_\_ Villa No: \_\_\_\_\_

Block: \_\_\_\_\_ Size: \_\_\_\_\_ Street No: \_\_\_\_\_ Category: \_\_\_\_\_

Total Cost: \_\_\_\_\_

Read, Understood & Signature: \_\_\_\_\_

Company Stamp & Signature \_\_\_\_\_

A Project of



Marketed by



**+92 51 848 8110**

Opal Villas, Adjacent Eden Life,  
Moza Herno, Thanda Pani, Islamabad  
opalvillas.isb@gmail.com | www.opalvillas.pk

## 3.5 MARLA SINGLE STOREY VILLA



Ground Floor



Roof Top





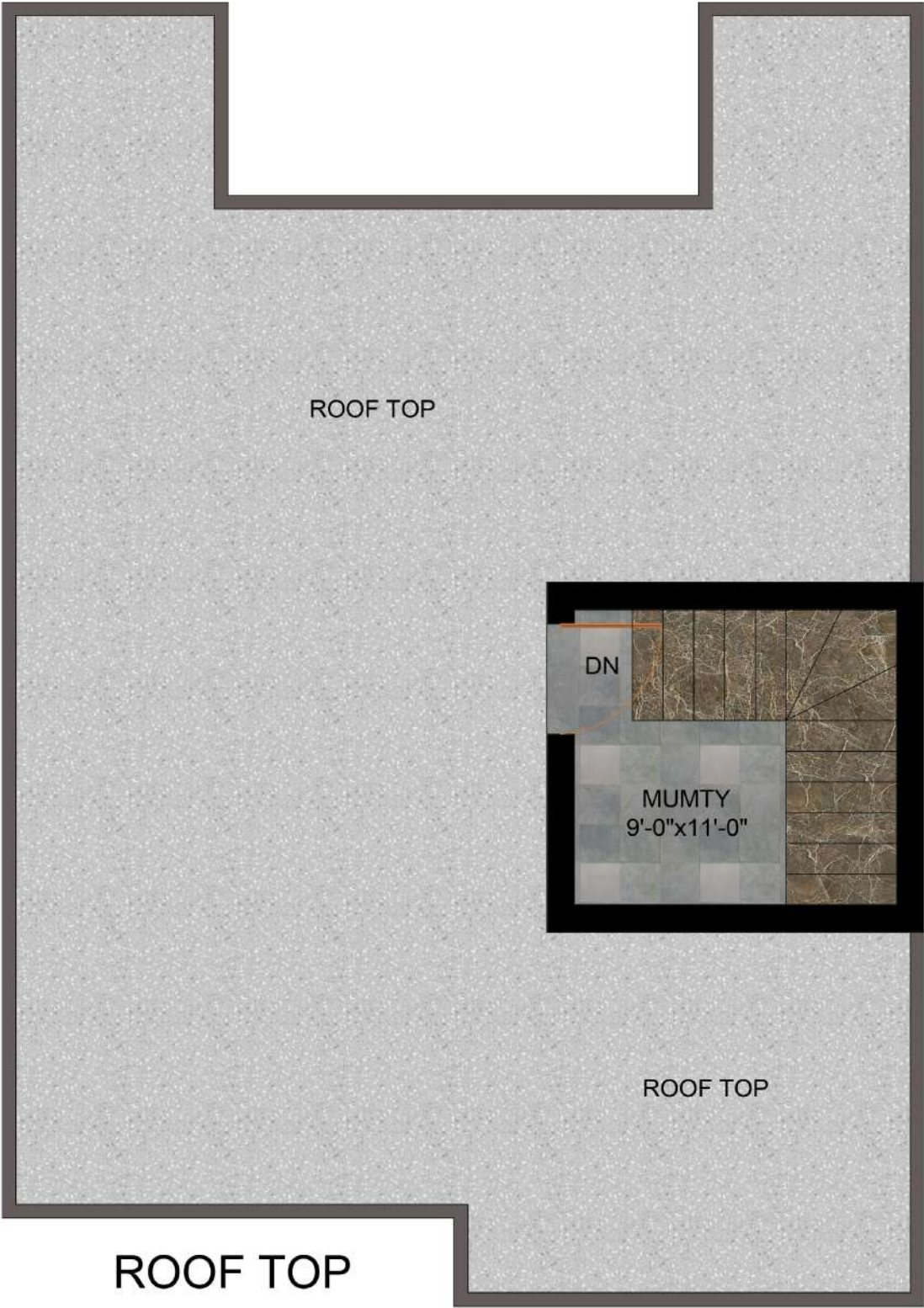

ROOF TOP

DN

MUMTY  
9'-0"x11'-0"

ROOF TOP

ROOF TOP





























